

# SISTEMI DI SUPPORTO – UNTERSTÜTZENDE SYSTEME

## PIPING SUPPORT SYSTEMS

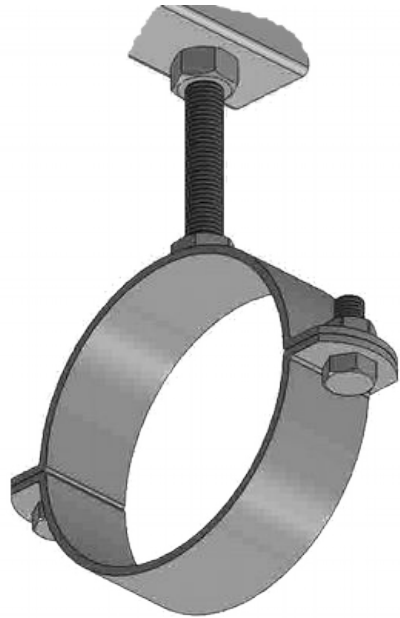

### Collari 620.R

Typology of material: *ElectroZinc Plated Steel*  
 Tipologia Materiale: *Acciaio Zincato galvanicamente*

Code / codice	φ [ " ]	φ [mm]	WxT [mm]	RS	ScxL	Load / Carico [N]
620.0 R	¼	12-15	20x1,5	M8/M10	M6x20	1000
620.1 R	3/8	15-19	20x1,5	M8/M10	M6x20	1000
620.2 R	½	20-24	20x1,5	M8/M10	M6x20	1000
620.3 R	¾	25-30	20x1,5	M8/M10	M6x20	1000
620.4 R	1	32-37	20x1,5	M8/M10	M6x20	1000
620.5 R	1 ¼	40-45	20x1,5	M8/M10	M6x25	1000
620.6 R	1 ½	48-53	20x2,0	M8/M10	M6x25	1300
620.7 R		54-58	20x2,0	M8/M10	M6x25	1300
620.8 R	2	59-63	20x2,0	M8/M10	M6x25	1300
620.9 R		68-73	20x2,0	M8/M10	M6x25	1300
620.10 R	2 ½	75-80	20x2,0	M8/M10	M6x25	1300
620.11 R	3	89-91	20x2,0	M8/M10	M6x25	1300
620.12 R		95-103	23x2,5	M8/M10	M6x25	2200
620.13 R		104-110	23x2,5	M8/M10	M6x25	2200
620.14 R	4	108-116	23x2,5	M8/M10	M8x25	2200
620.15 R		121-127	23x2,5	M8/M10	M8x25	2200
620.16 R	5	135-141	23x2,5	M8/M10	M8x25	2200
620.17 R	6	165-168	23x2,5	M8/M10	M8x25	2200
620.18 R		198-202	25x3,0	M8/M10	M8x25	2500
620.19 R	8	216-220	25x3,0	M8/M10	M8x25	2500
620.20 R		225	30x3,0	M8/M10	M8x25	2700
620.21 R		250	30x3,0	M8/M10	M8x25	2700
620.22 R		274-280	30x3,0	M8/M10	M8x25	2700
620.23 R		315	30x3,0	M8/M10	M8x25	2700

